

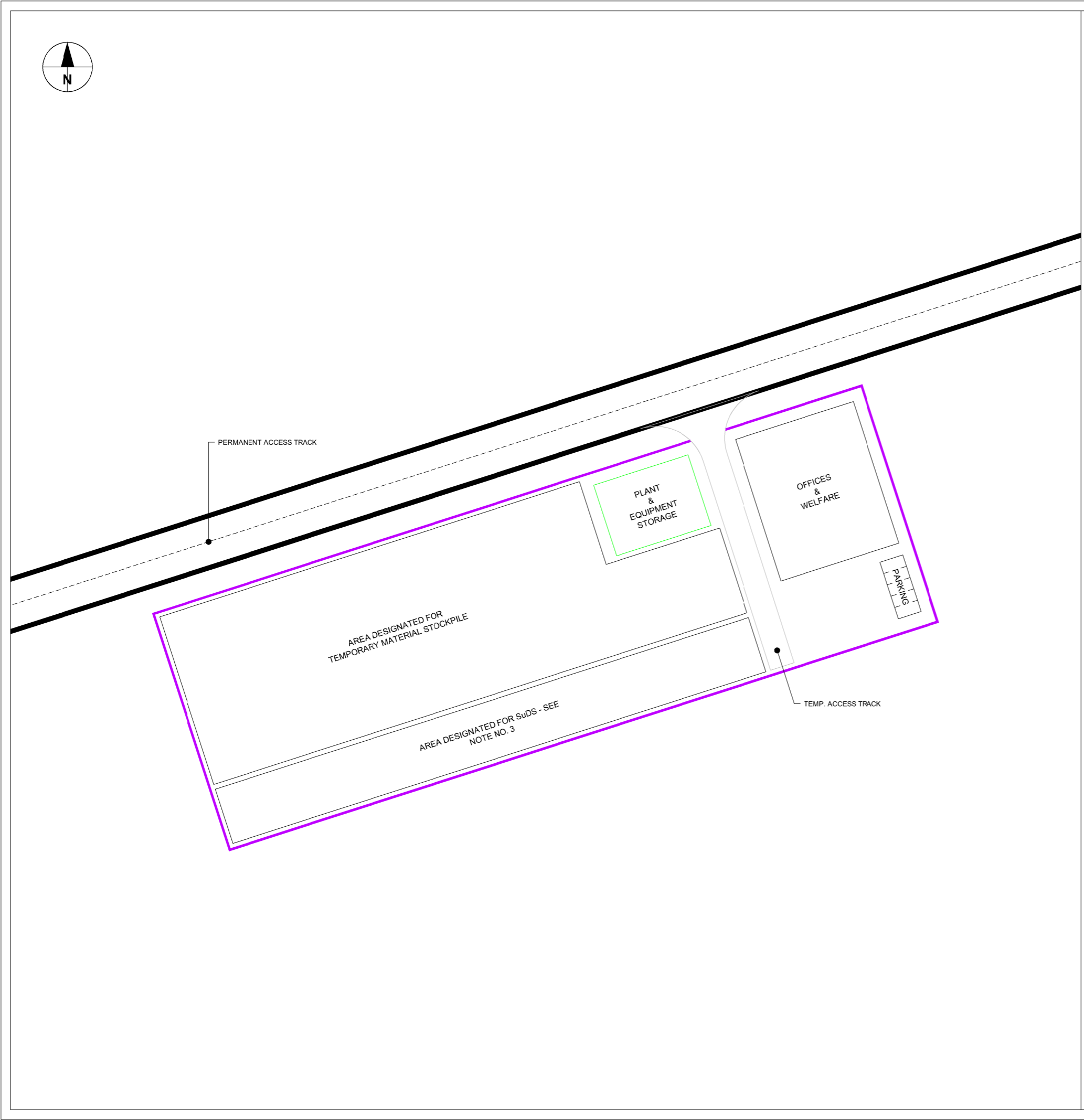

Project Management Initials: Designer: AC Checked: DH Approved: DL

Last saved by: AARON.CLEGHORN(2024-07-03) AutoCAD Version: 24.1S (LMS TECH) Filename: C:\P\WORKING\AECOM\_DS008\_UK\_2020\0485521\FIGURE 2\_19 COMPOUND TC08 INDICATIVE LAYOUT CONSTRUCTION PHASE DWG



### CONSTRUCTION COMPOUND DESIGN PRINCIPALS

1. PRIOR TO ANY ENABLING WORKS, NO TOPSOIL OR SUBSOIL STRIPPING SHOULD BE UNDERTAKEN WITHOUT THE WRITTEN PERMISSION OF THE HIGHLAND COUNCIL AND NATURESCOT (FORMERLY SCOTTISH NATURAL HERITAGE (SNH)). THIS SHOULD INCLUDE DETAILS OF ANY STORAGE OF MATERIALS AND LOCATIONS OF CONSTRUCTION ACCESS TRACKS.
2. ALL GROUNDWORKS, CLEARING LAND AND REPROFILING WILL TAKE INTO CONSIDERATION THE GUIDANCE CONTAINED WITHIN SCOTTISH ENVIRONMENT PROTECTION AGENCY'S (SEPA) SUPPORTING GUIDANCE (WAT-SG-75) SECTOR SPECIFIC GUIDANCE: CONSTRUCTION SITES (SEPT 2021)
3. BUNDS WILL BE USED WHERE REQUIRED TO MEET THE REQUIREMENTS OF SEPA'S POLLUTION PREVENTION GUIDELINES AND OIL STORAGE REGULATIONS:
  - 3.1. ALL FUEL SHALL BE STORED IN INTEGRAL BUNDED FUEL BOWERS, DESIGNED TO HOLD AT LEAST 110% OF THE CONTENTS OF THE TANK. FUEL SHALL BE STORED AT LEAST 20m AWAY FROM ANY WATERCOURSE, WHERE PRACTICABLE.
  - 3.2. ALL OIL AND LUBRICANTS SHALL BE STORED IN TEMPORARY IMPERMEABLE BUNDED AREAS OF SEALED BUNDED TANKS, DESIGNED TO HOLD AT LEAST 110% OF THE CONTENTS OF THE TANK. FUEL SHALL BE STORED AT LEAST 20m AWAY FROM ANY WATERCOURSE, WHERE PRACTICABLE.
4. ADEQUATE PARKING WILL BE PROVIDED TO ENSURE THAT THE SAFETY AND EFFICIENT OPERATION OF THE PUBLIC HIGHWAY IS NOT REDUCED;
5. WELFARE FACILITIES WILL BE PROVIDED TO MINIMISE THE NEED FOR OFFSITE TRIPS BY STAFF DURING THE WORKING DAY;
6. COMPOUND DESIGN AND LAYOUT WILL ENSURE THAT DUST EMISSION SOURCES ARE LOCATED AWAY FROM SENSITIVE RECEPTORS;
7. IF COMPOUND LIGHTING IS REQUIRED IT WILL BE DESIGNED TO MINIMISE LIGHT POLLUTION TO THE SURROUNDING AREA.
8. 50m BUFFER FROM ALL WATERCOURSES TO BE IMPLEMENTED AND ADHERED TO. WHERE THIS IS NOT POSSIBLE, ADDITIONAL MITIGATION TO AVOID POLLUTION OF WATERCOURSE WILL BE REQUIRED.
9. IF ON-SITE BATCHING FACILITIES ARE REQUIRED, THEY WILL BE OPERATED UNDER THE CONDITIONS OF THE APPROPRIATE AUTHORITY. WHERE POSSIBLE, BATCHING WILL BE CONDUCTED AT LEAST 50m FROM ANY WATERCOURSE WITH AN IMPERMEABLE HARSTANDING SUCH THAT SURFACE RUN OFF CAN BE INTERCEPTED FOR TREATMENT OR DISPOSAL OFF-SITE.



**PROJECT**  
Balliemeanoch  
Pumped Storage Hydro

**CLIENT**  
ILI (Borders PSH) Ltd.  
The Shires, 33 Bothwell Road  
Hamilton, ML3 0AS

**CONSULTANT**  
AECOM  
1 Tanfield  
Edinburgh, EH3 5DA  
+44 (0) 131 301 8630 tel 8699 fax  
www.AECOM.com

**LEGEND**  
— TEMP. COMPOUND

- NOTES**
1. DRAWING IS FOR INDICATIVE PURPOSES ONLY.
  2. TEMPORARY CONSTRUCTION COMPOUND SHOWN INDICATIVELY AND FINAL DESIGN WILL BE APPROVED BY THE CONTRACTOR. GENERAL PRINCIPALS THAT THE CONTRACTOR WILL FOLLOW SHOWN ON DRAWING.
  3. SUDS AREA SHOWN INDICATIVELY - TYPE AND SIZE ARE SUBJECT TO RUNOFF AND WILL BE DESIGNED BY CONTRACTOR AT THE DETAILED DESIGN STAGE.

**APPROVED FOR ISSUE**

A	AC	DH
I/R	DRAWN BY	CHECKED
		APPROVED

**ISSUE/REVISION**

A	JULY 2024	FINAL
I/R	DATE	DESCRIPTION

**SHEET TITLE**  
COMPOUND TC08  
INDICATIVE LAYOUT  
CONSTRUCTION PHASE

**FIGURE**  
Figure 2.19

**NOT FOR CONSTRUCTION**  
**FOR INFORMATION ONLY**

This drawing has been prepared for the use of AECOM's client. It may not be used, modified, reproduced or relied upon by third parties, except as agreed by AECOM or as required by law. AECOM accepts no responsibility, and denies any liability whatsoever, to any party that uses or relies on this drawing without AECOM's express written consent. All measurements must be obtained from the stated dimensions.